

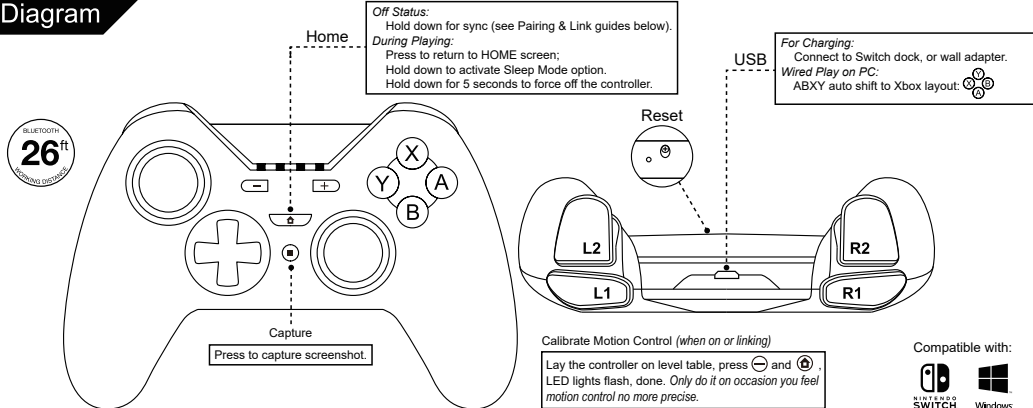

Wireless Controller for Nintendo Switch SG-N20W QUICK GUIDE v1.2

Diagram



Pairing

You only need to do pairing once when you have a new controller, or after a firmware upgrade, following the steps below:

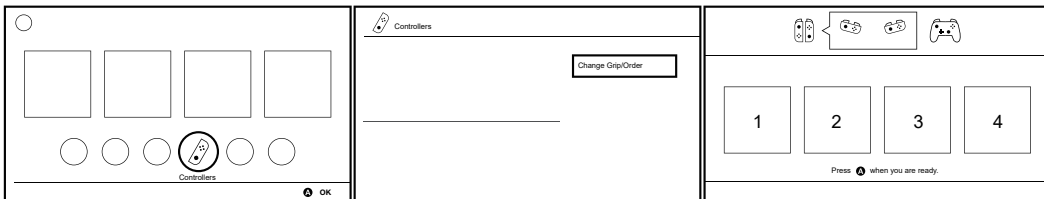

1 From the HOME screen, select "Controllers", then "Change Grip/Order", the pairing screen displayed, stay here.

① Operate by Joy-con, touch, or a paired controller. ⚠ Ignore the instruction of last screen.

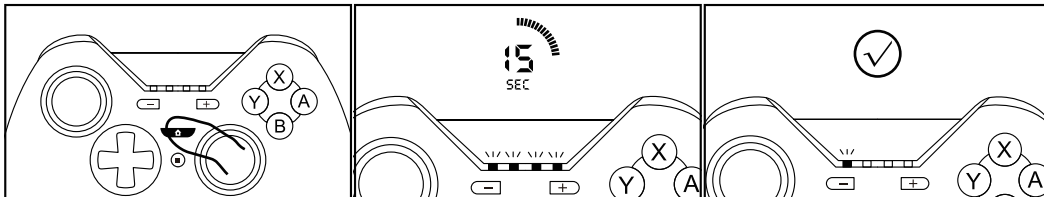

2 Hold down **+**.

3 Release when LED light on and twinkling quickly, then wait for around 10 seconds.

4 LED stops twinkling, certain light(s) on, done!

Link

If the controller has ever been paired, just following the steps below to turn on and reconnect to the console:

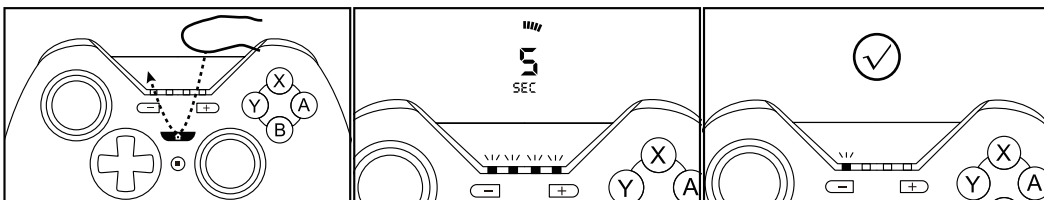

1 Press (not hold down) **Home**.

2 LED light on and twinkling slowly, then wait for around 5 seconds.

3 LED stops twinkling, certain light(s) on, done!